

LOCATION MAP
NOT TO SCALE

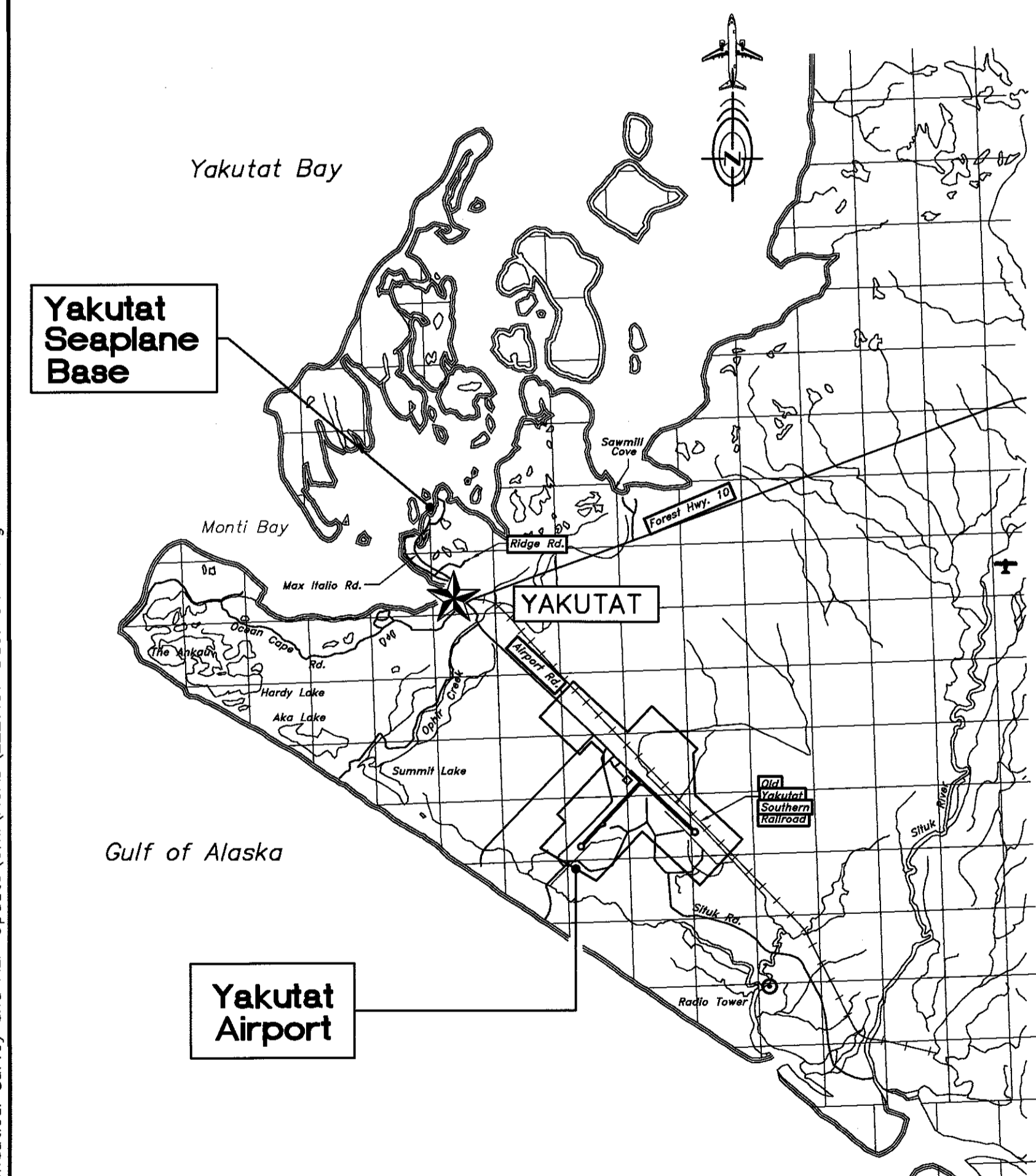

VICINITY MAP
NOT TO SCALE
USGS YAKUTAT (C-5, B-5)

AIRPORT DATA		
ITEM	EXISTING	ULTIMATE
IACO / NATIONAL AIRPORT IDENTIFIER	PAYA / YAK	SAME
FAA SITE NUMBER	50920.A	SAME
AIRPORT ELEVATION (NAVD 88)	39.4'	SAME
MEAN MAXIMUM TEMPERATURE, HOTTEST MONTH, 'F	60'	SAME
RAMP LIGHTING	NONE	NONE
AIRPORT NAVAIDS	LOC, DME, NDB, VORTAC	SAME
AIRPORT REFERENCE CODE (ARC)	C-III	SAME
MISC FACILITIES	ASOS, WINDCONE	SAME
CRITICAL AIRCRAFT	BOEING 737-400	BOEING 737-900
NPIAS SERVICE LEVEL	SMALL/NONHUB	SAME
OBSTRUCTION SURVEY SOURCE & TYPE	R&M CONSULTANTS, INC. 2015/VERTICALLY GUIDED AIRPORT AIRSPACE ANALYSIS SURVEY	

GEOGRAPHIC COORDINATES						
ITEM	EXISTING LATITUDE	EXISTING LONGITUDE	EXISTING ELEVATION	ULTIMATE LATITUDE	ULTIMATE LONGITUDE	ULTIMATE ELEVATION
ARP (ARP, NAD 83 DATUM)	N59° 30' 11.96"	W139° 39' 36.97"	39.4'	N59° 30' 09.71"	W139° 39' 44.35"	SAME
THRESHOLD RW 11	N59° 30' 41.25"	W139° 39' 52.89"	39.3'	SAME	SAME	SAME
THRESHOLD RW 29	N59° 29' 47.38"	W139° 38' 06.99"	32.7'	SAME	SAME	SAME
DISPLACED THRESHOLD RW 2	N59° 29' 56.26"	W139° 40' 46.53"	24.6'	N59° 29' 51.47"	W139° 40' 55.95"	23.12'
DISPLACED THRESHOLD RW 20	N/A	N/A	N/A	N59° 30' 27.51"	W139° 39' 45.10"	35.77'
THRESHOLD RW 2	N59° 29' 46.60"	W139° 41' 05.53"	21.4'	N59° 29' 38.41"	W139° 41' 21.62"	17.80'
THRESHOLD RW 20	N59° 30' 31.70"	W139° 39' 36.84"	36.9'	SAME	SAME	SAME

ULTIMATE RUNWAY 2/20 THRESHOLD COORDINATES ARE ESTIMATED. THE ACTUAL ULTIMATE RUNWAY END COORDINATES WILL BE SURVEYED DURING THE THRESHOLD RELOCATION AND TREE REMOVAL PROJECT.

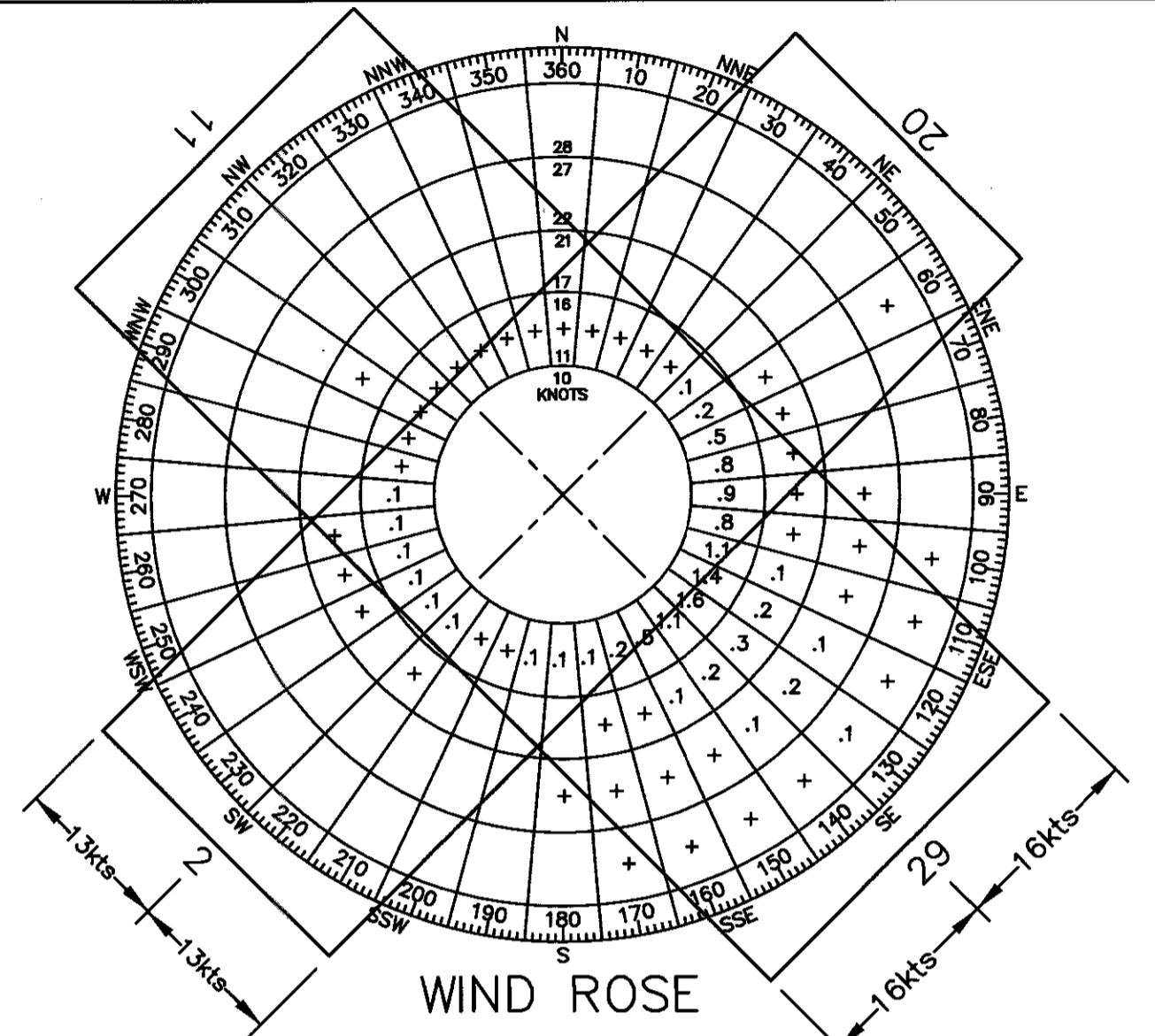

WIND ROSE
SOURCE: YAKUTAT AWOS PERIOD 1997-2001

WIND COVERAGE:

CROSSWIND COMPONENT	R/W 11/29	R/W 2/20	COMBINED
10 KNOTS (APPROACH CAT. A)	97.14%	90.01%	99.87%
13 KNOTS (APPROACH CAT. B)	99.12%	94.64%	99.93%
16 KNOTS (APPROACH CAT. C)	99.92%	98.03%	99.98%

RUNWAY 11/29 & 2/20 OTHER THAN UTILITY
2015 MAGNETIC DECLINATION IS 19°32'E AND CHANGES BY 0'19"W PER YEAR*
2010 EPOCH YEAR MAGNETIC DECLINATION IS 21°30'E AND CHANGES BY 0'18"W PER YEAR*
* DATA FROM NOAA

ITEM	RUNWAY 11/29		RUNWAY 2/20	
	EXISTING	ULTIMATE	EXISTING	ULTIMATE
RUNWAY DESIGN CODE (RDC)	C-III-2400	SAME	B-II-5000	C-III-5000
RUNWAY SURFACE	AC OVER PCC	SAME	AC OVER PCC	SAME
PAVEMENT STRENGTH	53/F/B/X/T	SAME	59/R/C/X/T	SAME
SURFACE TREATMENT	GROOVED	SAME	NONE	SAME
EFFECTIVE RUNWAY GRADIENT	0.12%	SAME	0.24%	SAME
% WIND COVERAGE	99.92%	SAME	98.03%	SAME
RUNWAY DIMENSIONS	150' X 7,732'	SAME	150' X 6,475'	150' X 7,650'
RUNWAY SAFETY AREA DIMENSIONS	500' X 9,745'	SAME	150' X 8,047'	500' X 8,650'
RUNWAY LIGHTING TYPE	HIRL	SAME	HIRL	SAME
RUNWAY PROTECTION ZONE (RPZ) DIMENSIONS	1000' X 1750' X 2500' / 500' X 1010' X 1700'	SAME/SAME	500' X 700' X 1000' / 500' X 700' X 1000'	500' X 1010' X 1700' / 500' X 1010' X 1700'
RUNWAY MARKING TYPE	PRECISION	SAME	NON-PRECISION	SAME
14 CFR PART 77 APPROACH CATEGORY	50:1/34:1	SAME	34:1/20:1	SAME
APPROACH TYPE	PRECISION/NON-PRECISION	SAME/SAME	NON-PRECISION/VISUAL	SAME/SAME
VISIBILITY MINIMUMS	< 3/4 MILE/1 MILE	SAME/SAME	1 MILE/VIS	SAME/SAME
RUNWAY DEPARTURE SURFACE	40:1/40:1	SAME	40:1/40:1	SAME
RUNWAY OBJECT FREE AREA (OFA) DIMENSION	800' X 9,745'	SAME	500' X 8,047'	800' X 8,047'
RUNWAY OBSTACLE FREE ZONE (OFZ) DIMENSION	400' X 8,145'	SAME	400' X 6,875'	400' X 7,949'
PRECISION OBSTACLE FREE ZONE	200' X 800' / N/A	SAME/SAME	N/A / N/A	SAME/SAME
THRESHOLD SITING SURFACE (TSS)	800' X 3800' X 10000' (34:1) / 350' X 1520' X 10000' (30:1)	SAME/SAME	400' X 1000' X 1500' X 8500' (20:1) / 350' X 1520' X 10000' (30:1)	SAME/SAME
RUNWAY NAVIGATION AIDS	VASI, MALSR, GS/LOC	SAME	PAPI, REILS	SAME
TOUCHDOWN ZONE ELEVATIONS	39.4'/32.7'	SAME/SAME	31.7'/37.0'	SAME/SAME

DECLARED DISTANCES				
ITEM	RUNWAY 2		RUNWAY 20	
	EXISTING	ULTIMATE	EXISTING	ULTIMATE
TAKE OFF RUN AVAILABLE (TORA)	6,475'	7,650'	5,087'	6,048'
TAKE OFF DISTANCE AVAILABLE (TODA)	6,475'	7,650'	5,087'	7,048'
ACCELERATE STOP DISTANCE AVAILABLE (ASDA)	6,475'	7,650'	6,475'	6,048'
LANDING DISTANCE AVAILABLE (LDA)	5,087'	5,775'	6,475'	6,048'

DRAWING INDEX	
SHEET #	TITLE
1	AIRPORT DATA SHEET
2	AIRPORT LAYOUT PLAN DRAWING
3	TERMINAL AREA DRAWING
4	INNER PORTION OF THE APPROACH SURFACE - RUNWAY 11
5	INNER PORTION OF THE APPROACH SURFACE - RUNWAY 29
6	INNER PORTION OF THE APPROACH SURFACE - RUNWAY 2-20
7	AIRPORT AIRSPACE PLAN
8	AIRPORT AIRSPACE PROFILES
9	LAND USE DRAWING
10	AIRPORT PROPERTY MAP

- NOTES:
- NAD 83 WAS USED AS THE HORIZONTAL DATUM FOR ALL COORDINATES.
 - NAVD88 WAS USED AS THE VERTICAL DATUM FOR ALL ELEVATIONS.

As-Built Sheets 3, 4, 6, 7 and 9 dated 11/7/2023 Accepted.

MODIFICATIONS TO STANDARDS				
DESCRIPTION	STANDARD	EXISTING	ULTIMATE	DISPOSITION
NONE REQUIRED				

ITEM	LEGEND	
	EXISTING	ULTIMATE
AIRPORT REFERENCE POINT		
ANTENNA		
BUILDINGS		
BUILDING NUMBER	1	
BUILDING RESTRICTION LINE	BRL	BRL
CONTOURS	100	100
FENCE		
MALSR		
PROPERTY LINE		
REIL		
ROADS (PAVED)		
ROADS (UNPAVED)		
ROTATING BEACON		
RUNWAY THRESHOLD LIGHTS		
SHORELINE		
STREAM / DRAINAGE		
THRESHOLD		
TREES		
TREES (INDIVIDUAL)		
UTILITY POLE		
VASI OR PAPI		
WIND CONE AND SEGMENTED CIRCLE		

Z:\Project\2227.01_DOT_SR_Yakutat_Airport_Aeronautical_Survey_and_ALP_Update\Civil\ACAD\2227.01-Data_Sheet.dwg

PLANNED: MIM
DRAWN: JC
CHECKED: EUG
DATE: 2/24/2017

STATE OF ALASKA
DEPARTMENT OF TRANSPORTATION
AND PUBLIC FACILITIES
SOUTHCOST REGION PLANNING

PREVIOUS REVISION DATE: JANUARY 7, 2010
APPROVED:
DATE: 6/10/17
VERNE SKAGERBERG, TRANSPORTATION PLANNER, FOR
ANDY HUGHES, CHIEF OF PLANNING

FAA AIRSPACE REVIEW NO: 2016-AAL-417-NRA
FAA APPROVAL DATE: 12/31/17
BY:
FAA AIRPORT DIVISION, ALASKA REGION, AAL-800
SUBJECT TO CONDITIONS IN LETTER DATED: 10/3/17
PREVIOUS ALP FAA APPROVAL DATE: JUNE 2, 2006

YAKUTAT AIRPORT
AIRPORT DATA SHEET

SHEET
1 OF 10

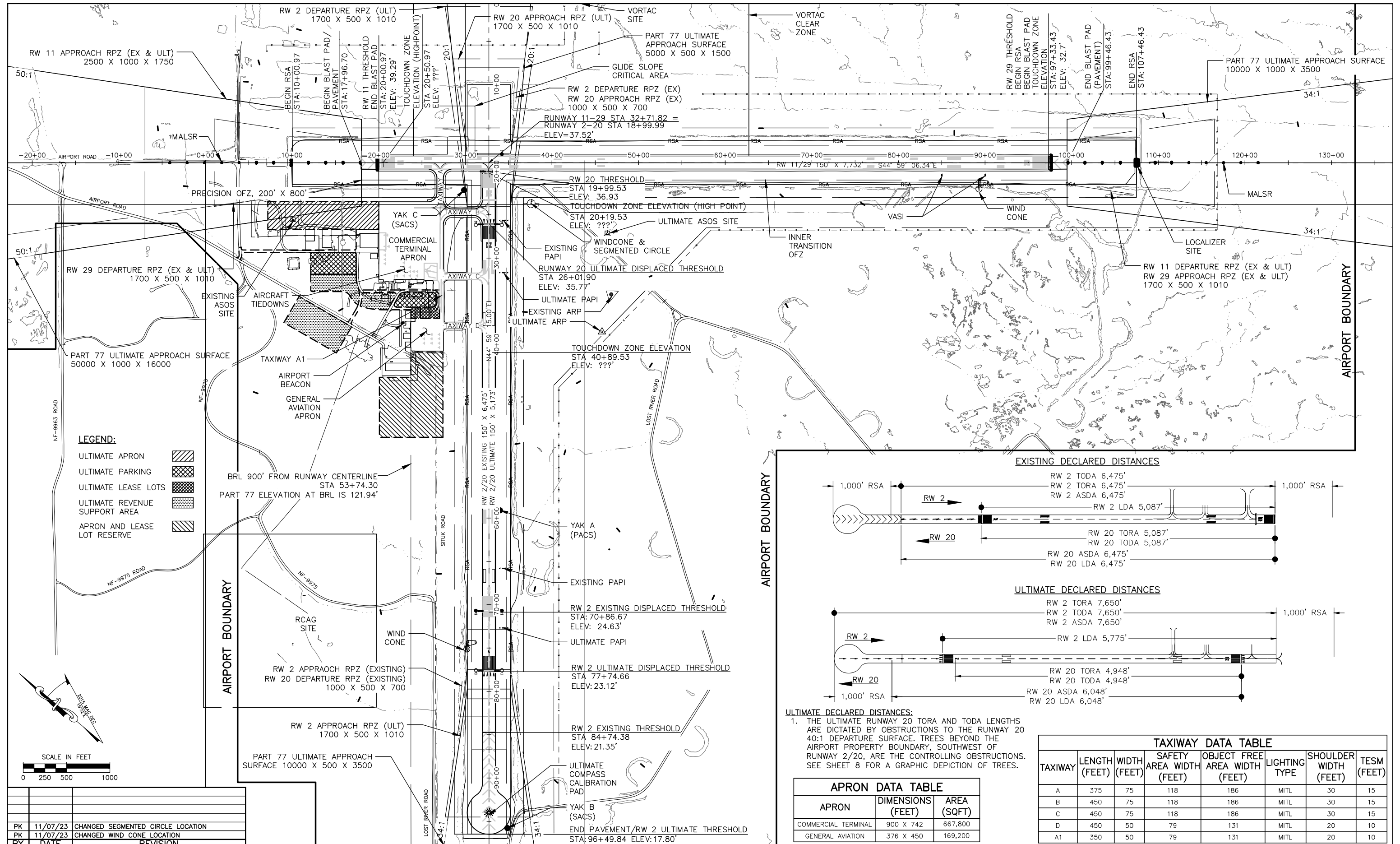

LEGEND:

- ULTIMATE APRON
- ULTIMATE PARKING
- ULTIMATE LEASE LOTS
- ULTIMATE REVENUE SUPPORT AREA
- APRON AND LEASE LOT RESERVE

BRL 900' FROM RUNWAY CENTERLINE
 STA 53+74.30
 PART 77 ELEVATION AT BRL IS 121.94'

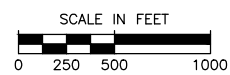

PK	DATE	REVISION
PK	11/07/23	CHANGED SEGMENTED CIRCLE LOCATION
PK	11/07/23	CHANGED WIND CONE LOCATION

PLANNED: MIM
 DRAWN: JC
 CHECKED: E.JG
 DATE: 2/24/2017

STATE OF ALASKA
 DEPARTMENT OF TRANSPORTATION
 AND PUBLIC FACILITIES
 SOUTHCOAST REGION PLANNING

PREVIOUS REVISION DATE: JANUARY 7, 2010
 APPROVED: _____
 DATE: _____
 VERNE SKAGERBERG, TRANSPORTATION PLANNER, FOR
 ANDY HUGHES, CHIEF OF PLANNING

FAA AIRSPACE REVIEW NO: _____
 FAA APPROVAL DATE: _____
 BY: _____
 FAA AIRPORT DIVISION, ALASKA REGION, AAL-600
 SUBJECT TO CONDITIONS IN LETTER DATED: _____
 PREVIOUS ALP FAA APPROVAL DATE: JUNE 2, 2006

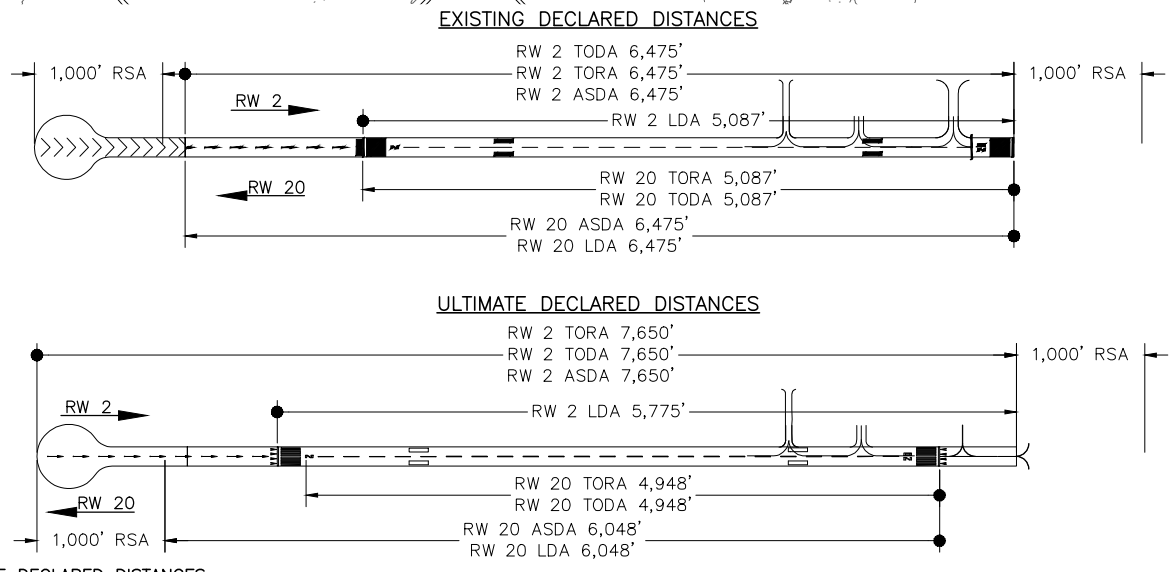

ULTIMATE DECLARED DISTANCES:
 1. THE ULTIMATE RUNWAY 20 TORA AND TODA LENGTHS ARE DICTATED BY OBSTRUCTIONS TO THE RUNWAY 20 40:1 DEPARTURE SURFACE. TREES BEYOND THE AIRPORT PROPERTY BOUNDARY, SOUTHWEST OF RUNWAY 2/20, ARE THE CONTROLLING OBSTRUCTIONS. SEE SHEET 8 FOR A GRAPHIC DEPICTION OF TREES.

APRON	DIMENSIONS (FEET)	AREA (SQFT)
COMMERCIAL TERMINAL	900 X 742	667,800
GENERAL AVIATION	376 X 450	169,200

TAXIWAY	LENGTH (FEET)	WIDTH (FEET)	SAFETY AREA WIDTH (FEET)	OBJECT FREE AREA WIDTH (FEET)	LIGHTING TYPE	SHOULDER WIDTH (FEET)	TESM (FEET)
A	375	75	118	186	MITL	30	15
B	450	75	118	186	MITL	30	15
C	450	75	118	186	MITL	30	15
D	450	50	79	131	MITL	20	10
A1	350	50	79	131	MITL	20	10

YAKUTAT AIRPORT
 AIRPORT LAYOUT PLAN DRAWING

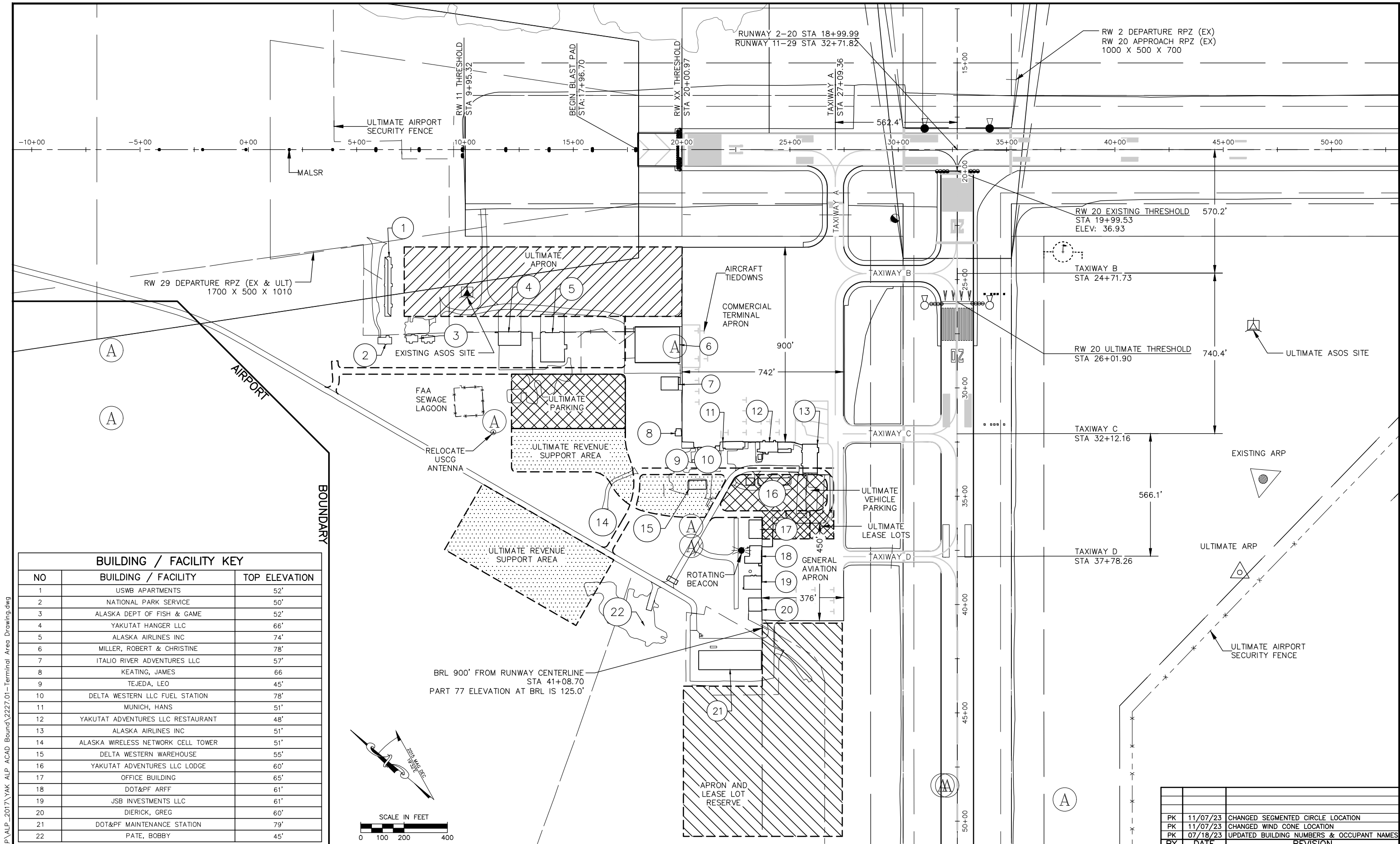

BUILDING / FACILITY KEY		
NO	BUILDING / FACILITY	TOP ELEVATION
1	USWB APARTMENTS	52'
2	NATIONAL PARK SERVICE	50'
3	ALASKA DEPT OF FISH & GAME	52'
4	YAKUTAT HANGER LLC	66'
5	ALASKA AIRLINES INC	74'
6	MILLER, ROBERT & CHRISTINE	78'
7	ITALIO RIVER ADVENTURES LLC	57'
8	KEATING, JAMES	66'
9	TEJEDA, LEO	45'
10	DELTA WESTERN LLC FUEL STATION	78'
11	MUNICH, HANS	51'
12	YAKUTAT ADVENTURES LLC RESTAURANT	48'
13	ALASKA AIRLINES INC	51'
14	ALASKA WIRELESS NETWORK CELL TOWER	51'
15	DELTA WESTERN WAREHOUSE	55'
16	YAKUTAT ADVENTURES LLC LODGE	60'
17	OFFICE BUILDING	65'
18	DOT&PF ARFF	61'
19	JSB INVESTMENTS LLC	61'
20	DIERICK, GREG	60'
21	DOT&PF MAINTENANCE STATION	79'
22	PATE, BOBBY	45'

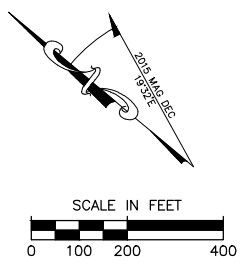

PLANNED: MIM
 DRAWN: JC
 CHECKED: EJC
 DATE: 2/24/2017

STATE OF ALASKA
 DEPARTMENT OF TRANSPORTATION
 AND PUBLIC FACILITIES
 SOUTHCOAST REGION PLANNING

PREVIOUS REVISION DATE: JANUARY 7, 2010
 APPROVED:
 VERNE SKAGERBERG, TRANSPORTATION PLANNER, FOR
 ANDY HUGHES, CHIEF OF PLANNING

FAA AIRSPACE REVIEW NO.:
 FAA APPROVAL DATE:
 BY:
 FAA AIRPORT DIVISION, ALASKA REGION, AAL-600
 SUBJECT TO CONDITIONS IN LETTER DATED:
 PREVIOUS ALP FAA APPROVAL DATE: JUNE 2, 2006

YAKUTAT AIRPORT
 TERMINAL AREA DRAWING

PK	DATE	REVISION
PK 11/07/23	11/07/23	CHANGED SEGMENTED CIRCLE LOCATION
PK 11/07/23	11/07/23	CHANGED WIND CONE LOCATION
PK 07/18/23	07/18/23	UPDATED BUILDING NUMBERS & OCCUPANT NAMES
BY	DATE	REVISION

SHEET
 3 OF 10

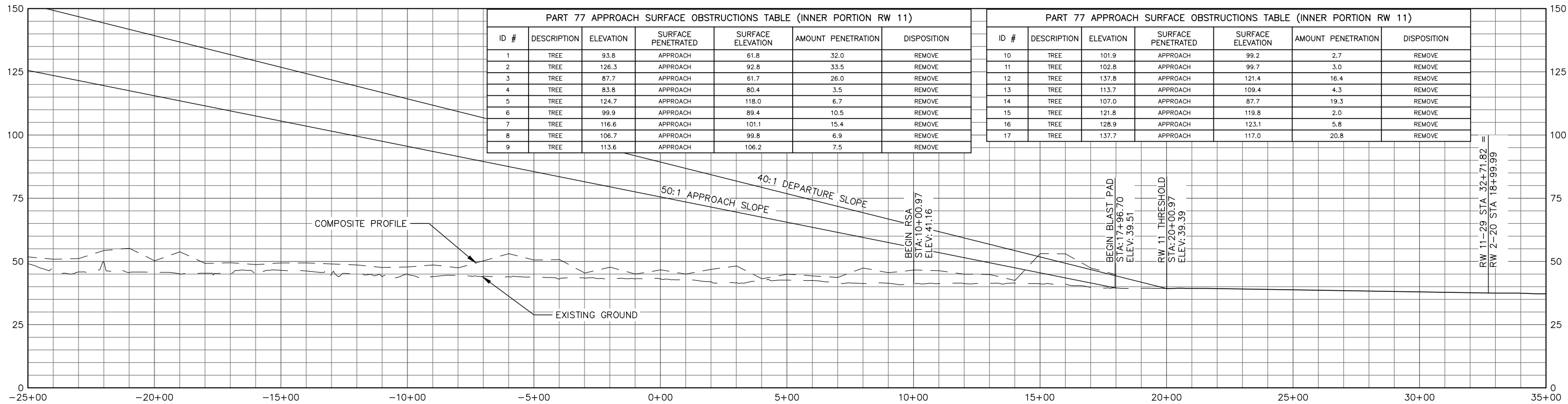
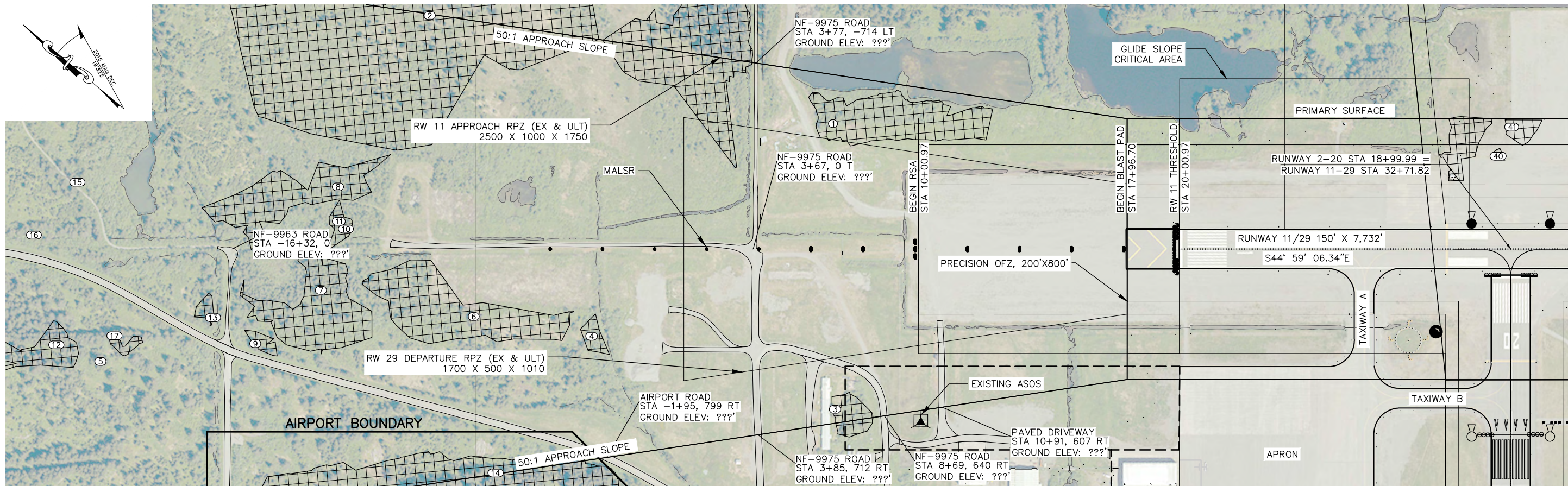

PART 77 APPROACH SURFACE OBSTRUCTIONS TABLE (INNER PORTION RW 11)

ID #	DESCRIPTION	ELEVATION	SURFACE PENETRATED	SURFACE ELEVATION	AMOUNT PENETRATION	DISPOSITION
1	TREE	93.8	APPROACH	61.8	32.0	REMOVE
2	TREE	126.3	APPROACH	92.8	33.5	REMOVE
3	TREE	87.7	APPROACH	61.7	26.0	REMOVE
4	TREE	83.8	APPROACH	80.4	3.5	REMOVE
5	TREE	124.7	APPROACH	118.0	6.7	REMOVE
6	TREE	99.9	APPROACH	89.4	10.5	REMOVE
7	TREE	116.6	APPROACH	101.1	15.4	REMOVE
8	TREE	106.7	APPROACH	99.8	6.9	REMOVE
9	TREE	113.6	APPROACH	106.2	7.5	REMOVE

PART 77 APPROACH SURFACE OBSTRUCTIONS TABLE (INNER PORTION RW 11)

ID #	DESCRIPTION	ELEVATION	SURFACE PENETRATED	SURFACE ELEVATION	AMOUNT PENETRATION	DISPOSITION
10	TREE	101.9	APPROACH	99.2	2.7	REMOVE
11	TREE	102.8	APPROACH	99.7	3.0	REMOVE
12	TREE	137.8	APPROACH	121.4	16.4	REMOVE
13	TREE	113.7	APPROACH	109.4	4.3	REMOVE
14	TREE	107.0	APPROACH	87.7	19.3	REMOVE
15	TREE	121.8	APPROACH	119.8	2.0	REMOVE
16	TREE	128.9	APPROACH	123.1	5.8	REMOVE
17	TREE	137.7	APPROACH	117.0	20.8	REMOVE

- NOTES:**
- THRESHOLD SITING CRITERIA FOR RUNWAY 11 IS DEFINED BY AC 150/5300-13A, TABLE 3-2, LINE 8.
 - REFER TO THE AIRPORT AIRSPACE DRAWING FOR PENETRATIONS TO THE OUTER APPROACH SURFACES.
 - DEPARTURE SURFACE SLOPE IS 40:1 AS DEFINED BY AC150/5300-13A, TABLE 3-2, LINE 9 FOR INSTRUMENT RUNWAYS.
 - A CLEAR LINE OF SIGHT EXISTS ALONG THE RUNWAY CENTERLINE.

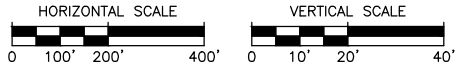

LEGEND:
 PART 77 INNER APPROACH SURFACE PENETRATION AREA

PK	DATE	REVISION
PK 11/07/23	11/07/23	CHANGED SEGMENTED CIRCLE LOCATION
PK 11/07/23	11/07/23	CHANGED WIND CONE LOCATION

PLANNED: MIM
 DRAWN: JC
 CHECKED: E.JG
 DATE: 2/24/2017

STATE OF ALASKA
 DEPARTMENT OF TRANSPORTATION
 AND PUBLIC FACILITIES
 SOUTHCOAST REGION PLANNING

PREVIOUS REVISION DATE: JANUARY 7, 2010
 APPROVED:
 VERNE SKAGERBERG, TRANSPORTATION PLANNER, FOR
 ANDY HUGHES, CHIEF OF PLANNING

FAA AIRSPACE REVIEW NO:
 FAA APPROVAL DATE:
 BY: FAA AIRPORT DIVISION, ALASKA REGION, AAL-600
 SUBJECT TO CONDITIONS IN LETTER DATED:
 PREVIOUS ALP FAA APPROVAL DATE: JUNE 2, 2006

YAKUTAT AIRPORT
 INNER PORTION OF THE APPROACH
 SURFACE - RUNWAY 11

SHEET
 4 OF
 10

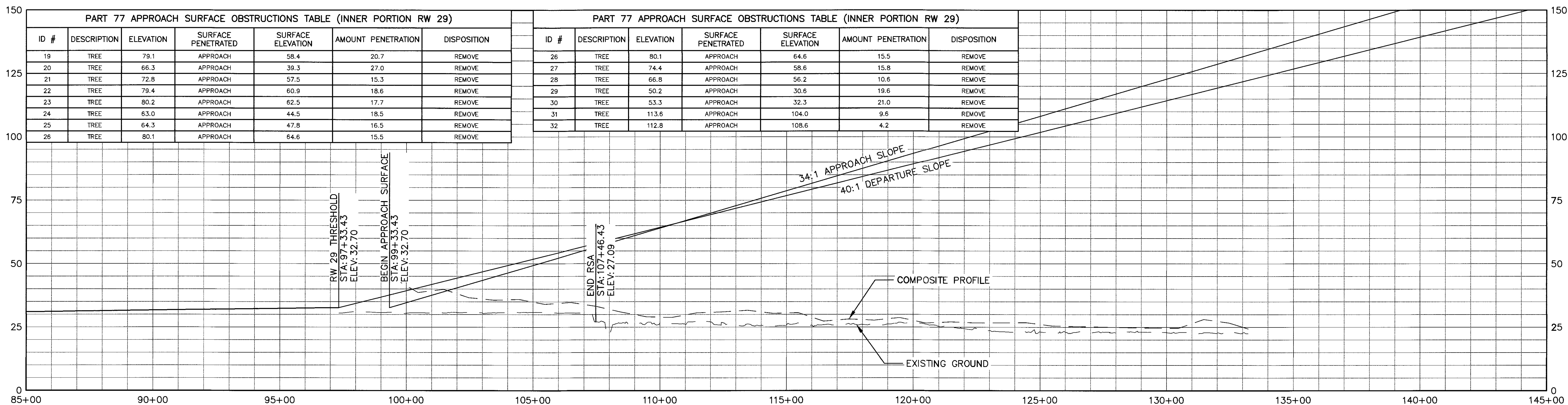
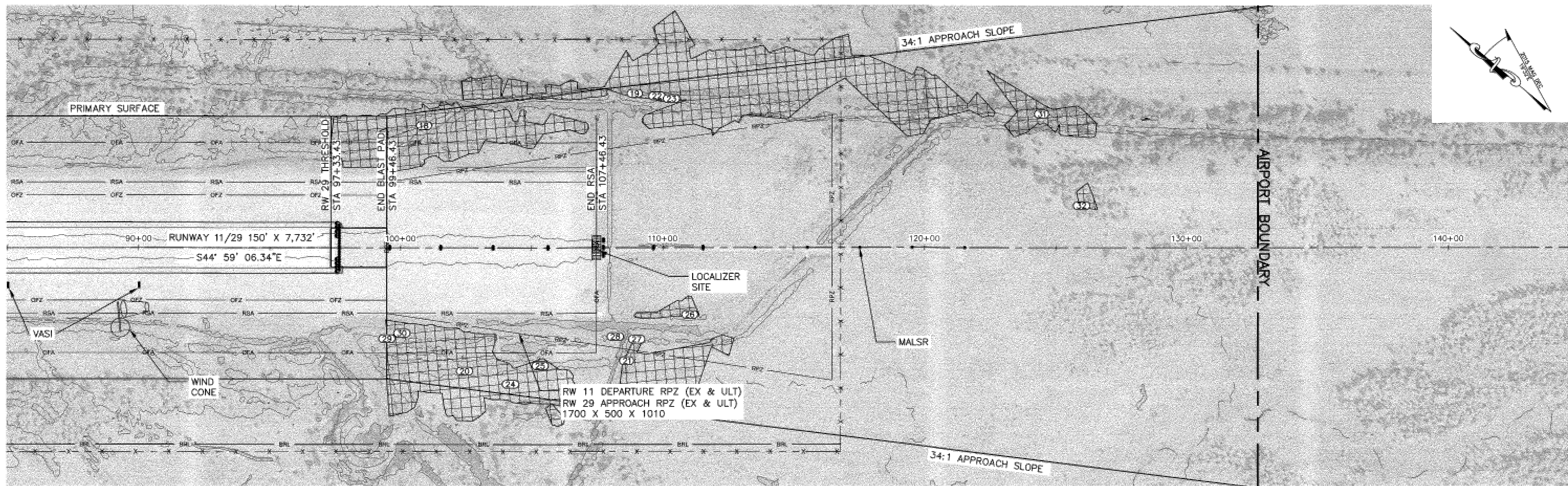

- NOTES:
1. THRESHOLD SITING CRITERIA FOR RUNWAY 29 IS DEFINED BY AC 150/5300-13A, TABLE 3-2, LINE 5.
 2. REFER TO THE AIRPORT AIRSPACE DRAWING FOR PENETRATIONS TO THE OUTER APPROACH SURFACES.
 3. DEPARTURE SURFACE SLOPE IS 40:1 AS DEFINED BY AC 150/5300-13A, TABLE 3-2, LINE 9 FOR INSTRUMENT RUNWAYS.
 4. A CLEAR LINE OF SIGHT EXISTS ALONG THE RUNWAY CENTERLINE.

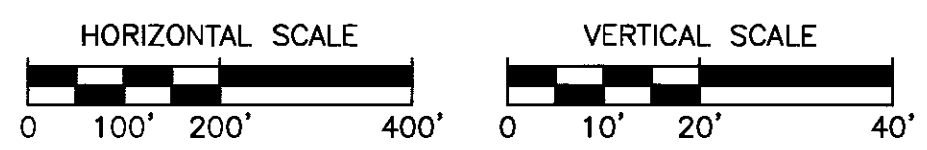

LEGEND:
 PART 77 INNER APPROACH SURFACE PENETRATION AREA

PLANNED: MIM
 DRAWN: JC
 CHECKED: EJJ
 DATE: 2/24/2017

STATE OF ALASKA
 DEPARTMENT OF TRANSPORTATION
 AND PUBLIC FACILITIES
 SOUTHCOAST REGION PLANNING

PREVIOUS REVISION DATE: JANUARY 7, 2010
 APPROVED:
 VERNE SKAGERBERG, TRANSPORTATION PLANNER, FOR
 ANDY HUGHES, CHIEF OF PLANNING

FAA AIRSPACE REVIEW NO: _____
 FAA APPROVAL DATE: _____
 BY: _____
 FAA AIRPORT DIVISION, ALASKA REGION, AAL-600
 SUBJECT TO CONDITIONS IN LETTER DATED: _____
 PREVIOUS ALP FAA APPROVAL DATE: JUNE 2, 2006

YAKUTAT AIRPORT
 INNER PORTION OF THE APPROACH
 SURFACE - RUNWAY 29

SHEET
 5 OF 10

Z:\project\2227.01_DOT_SR_Yakutat Airport Aeronautical Survey and ALP Update\Civil\ACAD\2227.01-Inner_Approach.dwg

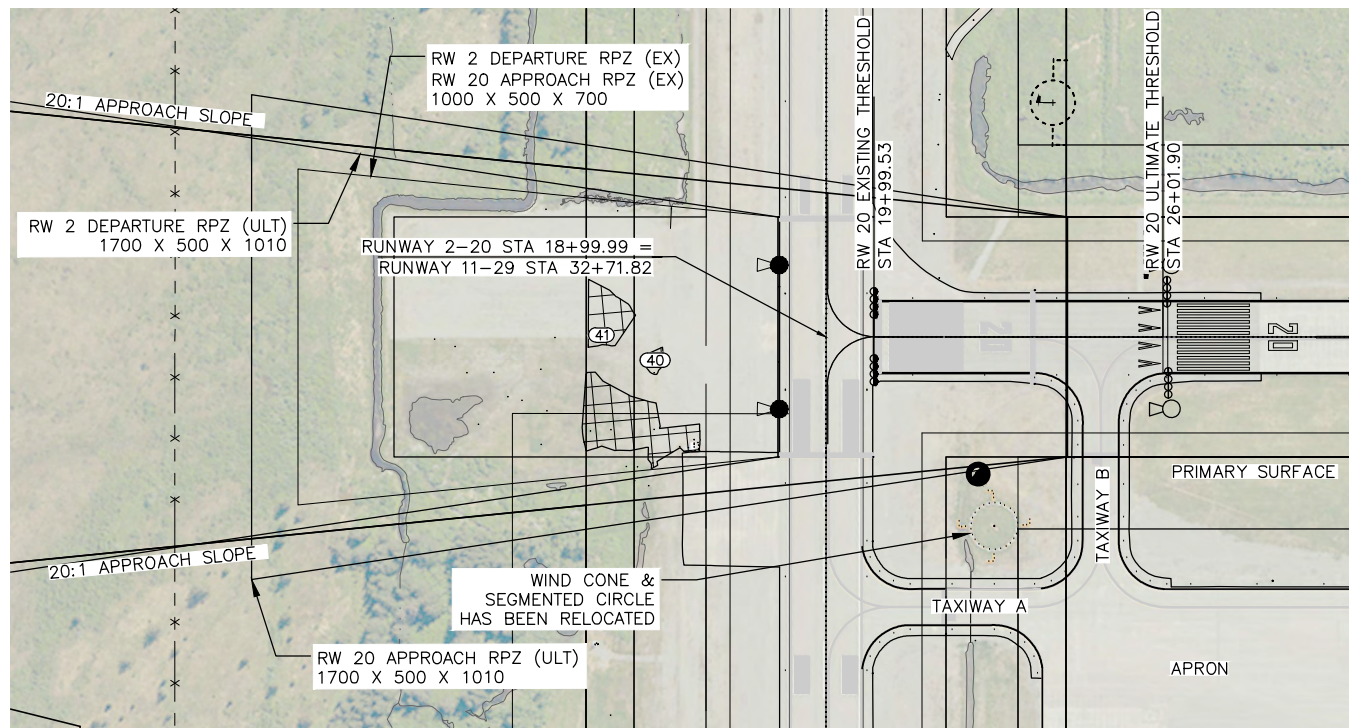

RUNWAY 20 APPROACH PLAN

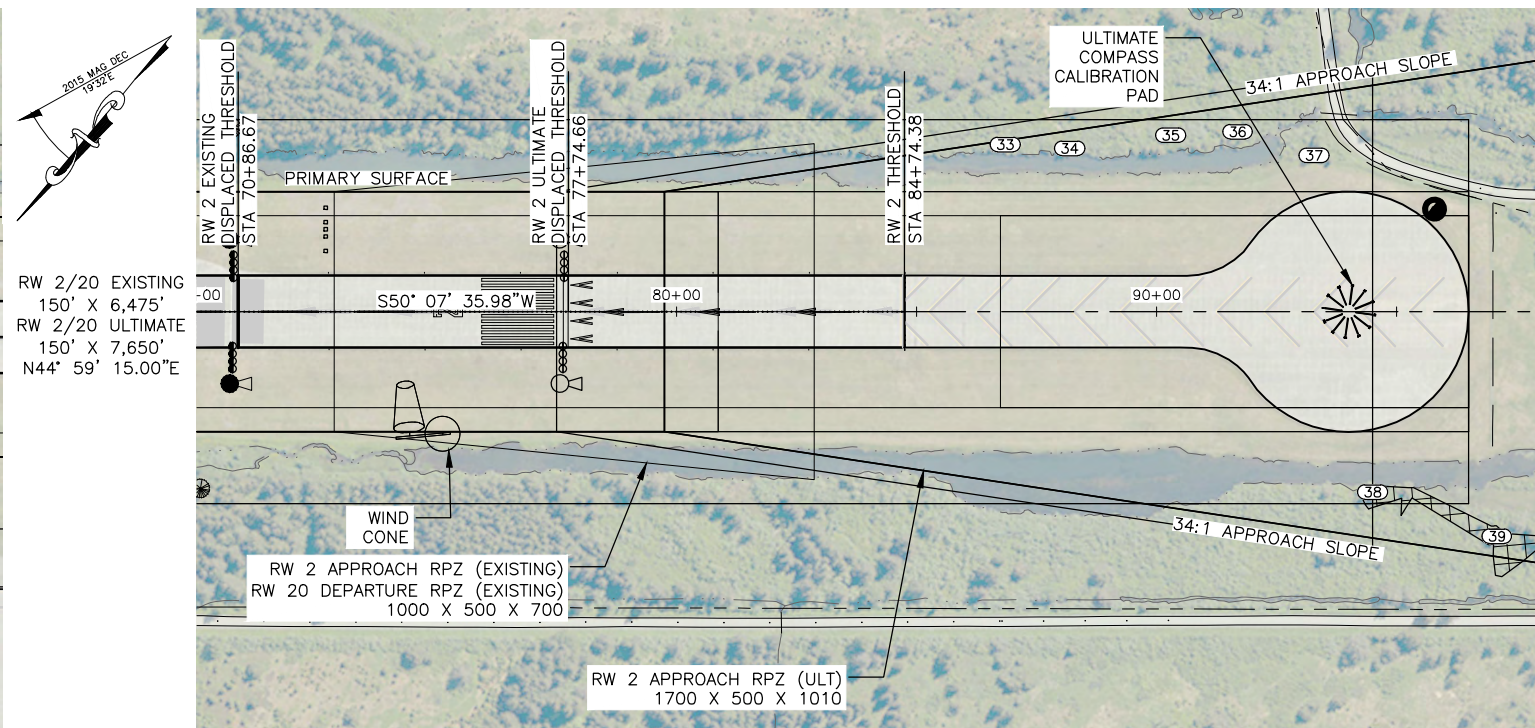

RUNWAY 02 APPROACH PLAN

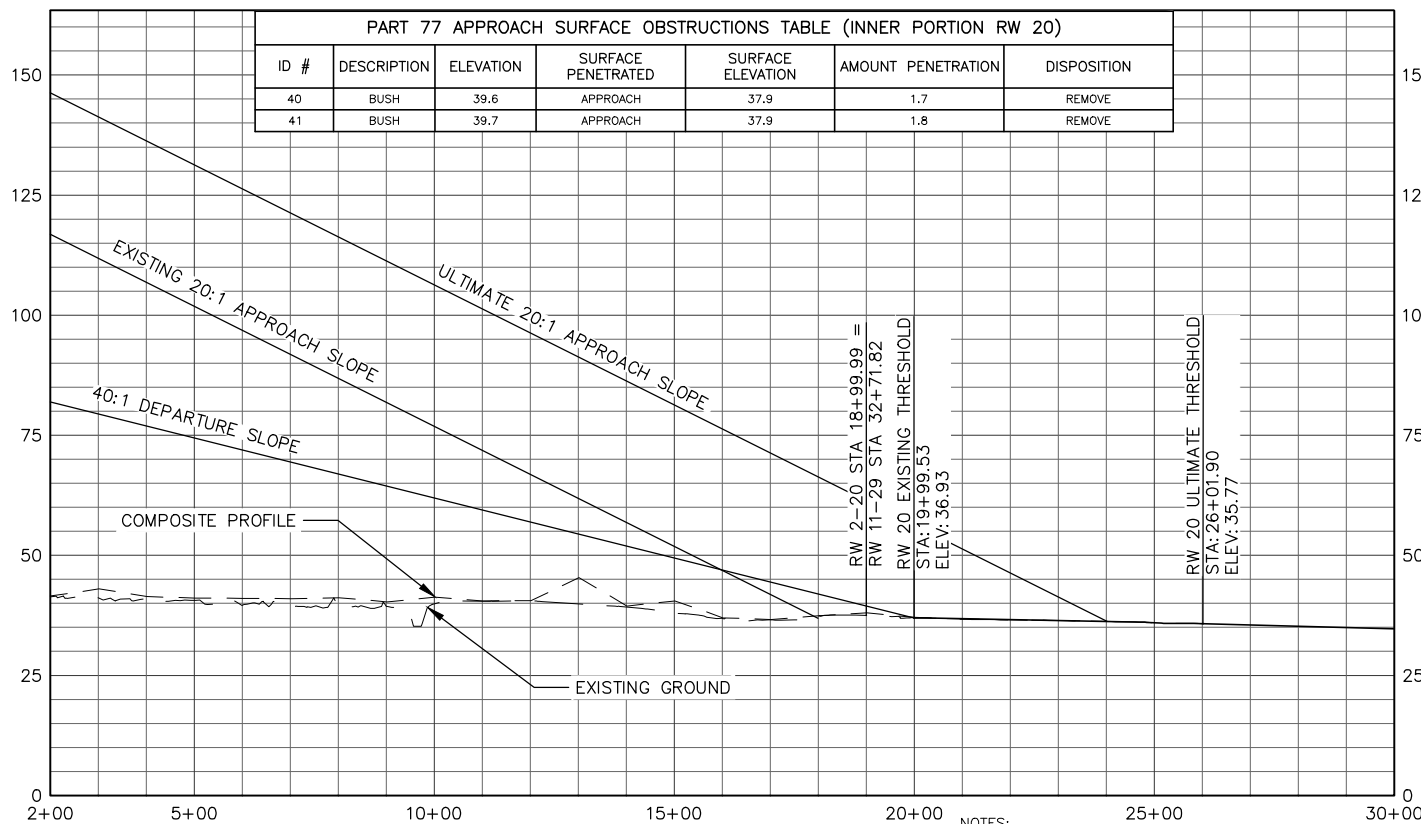

RUNWAY 20 APPROACH PROFILE



- THRESHOLD SITING CRITERIA FOR RUNWAY 2 IS DEFINED BY AC 150/5300-13A, TABLE 3-2, LINE 4 FOR THE EXISTING CONDITION AND LINE 5 FOR ULTIMATE. THRESHOLD SITING CRITERIA FOR RUNWAY 20 IS DEFINED BY AC 150/5300-13A, TABLE 3-2, LINE 3.
- REFER TO THE AIRPORT AIRSPACE DRAWING FOR PENETRATIONS TO THE OUTER APPROACH SURFACES.
- DEPARTURE SURFACE SLOPE IS 40:1 AS DEFINED BY AC 150/5300-13A, TABLE 3-2, LINE 9 FOR INSTRUMENT RUNWAYS.
- A CLEAR LINE OF SIGHT EXISTS ALONG THE RUNWAY CENTERLINE.

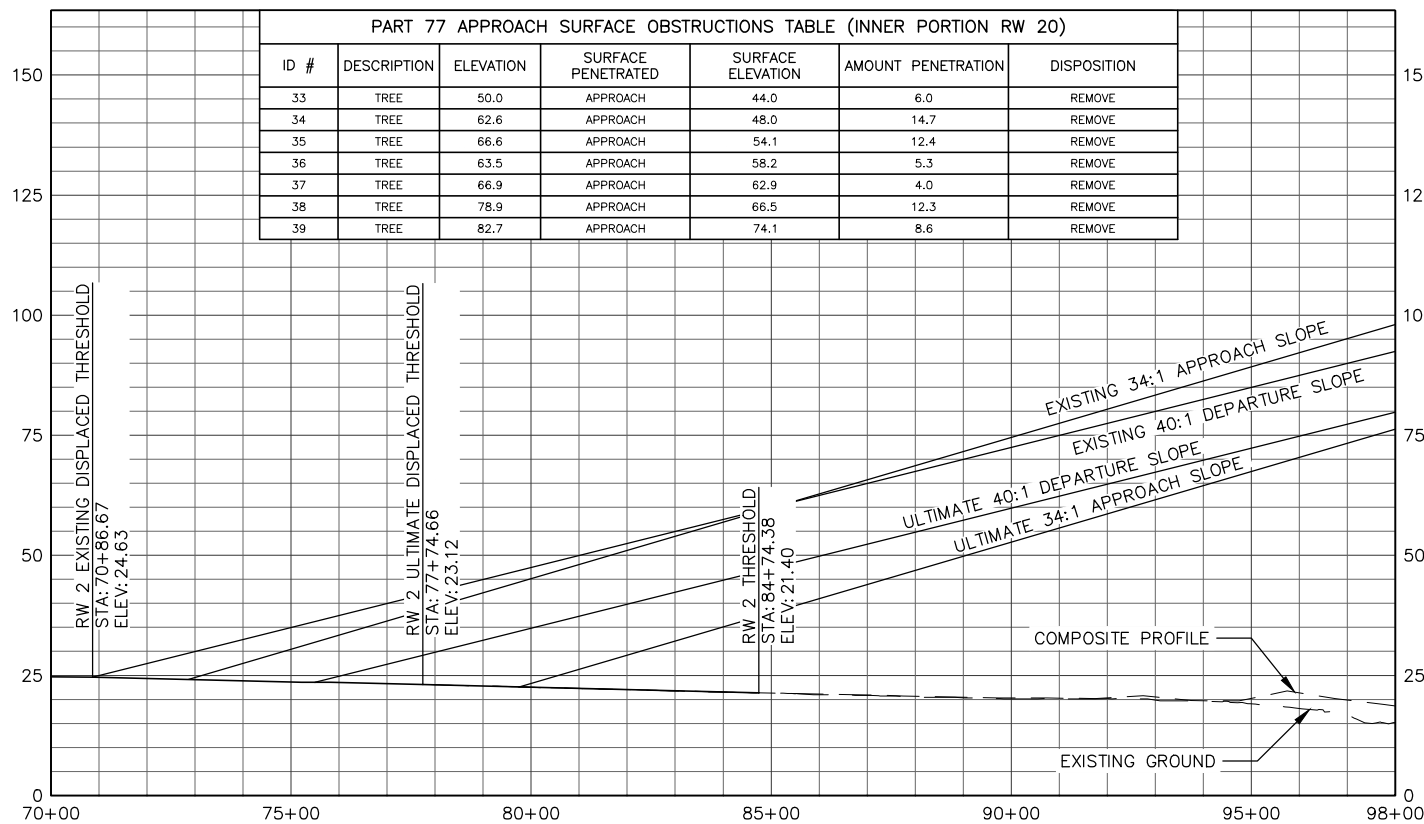

RUNWAY 02 APPROACH PROFILE

LEGEND:

PART 77 INNER APPROACH SURFACE PENETRATION AREA

PK	DATE	REVISION
PK 11/07/23	11/07/23	CHANGED SEGMENTED CIRCLE LOCATION
PK 11/07/23	11/07/23	CHANGED WIND CONE LOCATION

PLANNED: MIM
DRAWN: JC
CHECKED: E.JG
DATE: 2/24/2017

STATE OF ALASKA
DEPARTMENT OF TRANSPORTATION
AND PUBLIC FACILITIES
SOUTHCOST REGION PLANNING

PREVIOUS REVISION DATE: JANUARY 7, 2010
APPROVED:
DATE:
VERNE SKAGERBERG, TRANSPORTATION PLANNER, FOR
ANDY HUGHES, CHIEF OF PLANNING

FAA AIRSPACE REVIEW NO:
FAA APPROVAL DATE:
BY:
FAA AIRPORT DIVISION, ALASKA REGION, AAL-600
SUBJECT TO CONDITIONS IN LETTER DATED:
PREVIOUS ALP FAA APPROVAL DATE: JUNE 2, 2006

YAKUTAT AIRPORT
INNER PORTION OF APPROACH
SURFACE - RUNWAY 2-20

SHEET
6 OF
10

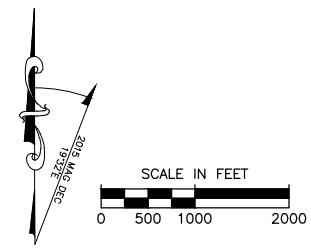
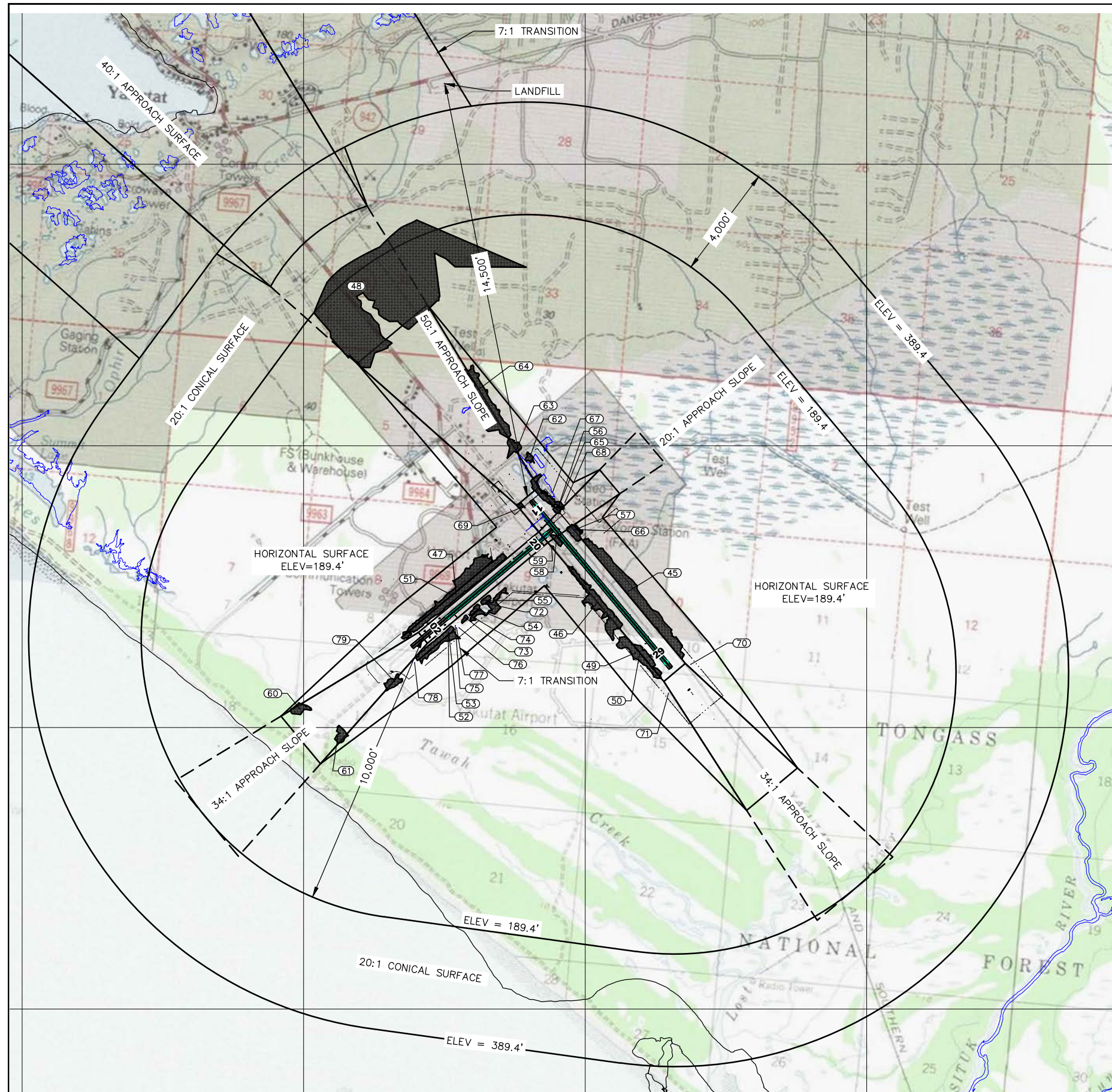

PART 77 SURFACE OBSTRUCTIONS TABLE

ID #	DESCRIPTION	ELEVATION	SURFACE PENETRATED	SURFACE ELEVATION	AMOUNT PENETRATION	DISPOSITION
45	TREE	126.8	TRANSITIONAL	46.3	80.5	REMOVE
46	TREE	125.8	TRANSITIONAL	35.0	90.8	REMOVE
47	TREE	135.3	TRANSITIONAL	48.5	86.8	REMOVE
48	TREE	221.7	APPROACH	189.4	32.3	REMOVE
49	TREE	139.9	TRANSITIONAL	45.3	94.6	REMOVE
50	TREE	90.7	TRANSITIONAL	31.8	58.8	REMOVE
51	TREE	136.7	TRANSITIONAL	64.5	72.2	REMOVE
52	TREE	125.2	TRANSITIONAL	45.0	80.2	REMOVE
53	TREE	123.5	TRANSITIONAL	66.0	57.4	REMOVE
54	TREE	125.4	TRANSITIONAL	46.0	79.5	REMOVE
55	TREE	124.4	TRANSITIONAL	44.2	80.2	REMOVE
56	TREE	136.3	TRANSITIONAL	64.4	71.9	REMOVE
57	TREE	106.1	TRANSITIONAL	40.6	65.5	REMOVE
58	ROAD	49.1	PRIMARY	37.4	11.7	REMAIN
59	WINDCONE	60.5	PRIMARY	38.9	21.6	REMAIN, OBSTRUCTION LIGHTED
60	TREE	183.1	APPROACH	169.1	13.9	REMOVE
61	TREE	167.5	APPROACH	156.9	10.6	REMOVE
62	TREE	145.4	TRANSITIONAL	103.6	41.7	REMOVE
63	TREE	131.5	TRANSITIONAL	73.9	57.6	REMOVE
64	TREE	163.2	TRANSITIONAL	124.2	39.1	REMOVE
65	TREE	105.7	TRANSITIONAL	41.5	64.2	REMOVE
66	TREE	107.2	TRANSITIONAL	58.3	48.8	REMOVE
67	TREE	123.1	TRANSITIONAL	81.0	42.1	REMOVE
68	TREE	125.1	TRANSITIONAL	79.3	45.8	REMOVE
69	TREE	39.8	PRIMARY	39.3	0.5	REMOVE
70	TREE	102.1	TRANSITIONAL	49.7	52.5	REMOVE
71	TREE	110.0	TRANSITIONAL	55.6	54.4	REMOVE
72	TREE	130.5	TRANSITIONAL	72.5	58.0	REMOVE
73	TREE	98.0	TRANSITIONAL	47.3	50.7	REMOVE
74	TREE	94.8	TRANSITIONAL	48.0	46.7	REMOVE
75	TREE	102.5	TRANSITIONAL	46.5	56.1	REMOVE
76	TREE	131.3	TRANSITIONAL	68.5	62.9	REMOVE
77	TREE	120.8	TRANSITIONAL	59.9	60.8	REMOVE
78	TREE	100.4	TRANSITIONAL	63.3	37.0	REMOVE
79	TREE	116.7	TRANSITIONAL	82.0	34.6	REMOVE

NOTES:

- AIRPORT ELEVATION IS 39.4'.
- REFER TO THE INNER PORTION OF THE APPROACH SURFACE AND THE AIRPORT LAYOUT PLAN DRAWINGS FOR CLOSE IN OBSTRUCTIONS.
- PRIMARY SURFACE WIDTH IS 1000 FEET FOR RUNWAY 11-29 AND 500 FEET FOR RUNWAY 02-20.
- PART 77 SURFACES BASED ON ULTIMATE AIRPORT LAYOUT.

LEGEND:

PART 77 SURFACE PENETRATION AREA

PK	DATE	REVISION
PK 11/07/23	11/07/23	UPDATED OBSTRUCTION #59 FOR THE NEW WIND CONE LOCATION
PK 11/07/23	11/07/23	CHANGED SEGMENTED CIRCLE LOCATION
PK 11/07/23	11/07/23	CHANGED WIND CONE LOCATION

PLANNED: MIM
 DRAWN: JC
 CHECKED: EJC
 DATE: 2/24/2017

STATE OF ALASKA
 DEPARTMENT OF TRANSPORTATION
 AND PUBLIC FACILITIES
 SOUTHCOST REGION PLANNING

PREVIOUS REVISION DATE: JANUARY 7, 2010
 APPROVED: _____
 DATE: _____
 VERNE SKAGERBERG, TRANSPORTATION PLANNER, FOR
 ANDY HUGHES, CHIEF OF PLANNING

FAA AIRSPACE REVIEW NO: _____
 FAA APPROVAL DATE: _____
 BY: _____
 FAA AIRPORT DIVISION, ALASKA REGION, AAL-600
 SUBJECT TO CONDITIONS IN LETTER DATED: _____
 PREVIOUS ALP FAA APPROVAL DATE: JUNE 2, 2006

**YAKUTAT AIRPORT
 AIRPORT AIRSPACE PLAN**

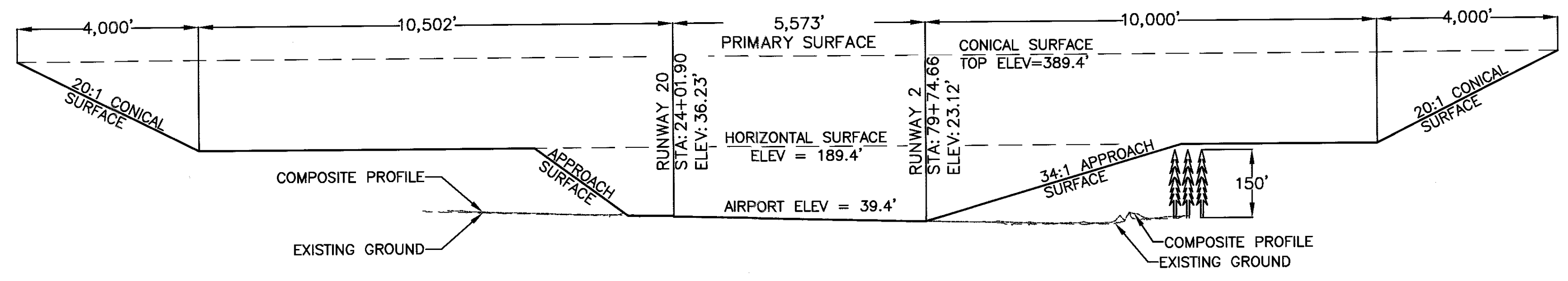

RUNWAY 02-20

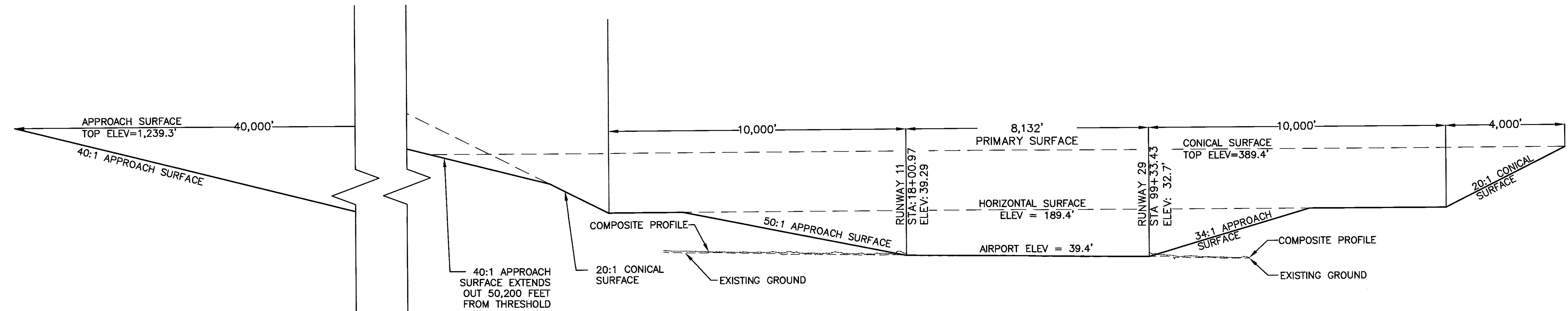

RUNWAY 11-29

Z:\project\2227.01 DOT_SR Yakutat Airport Aeronautical Survey and ALP Update\Civil\ACAD\2227.01-Airspace.dwg

PLANNED: MIM
 DRAWN: JC
 CHECKED: EJJ
 DATE: 2/24/2017

STATE OF ALASKA
 DEPARTMENT OF TRANSPORTATION
 AND PUBLIC FACILITIES
 SOUTHCOAST REGION PLANNING

PREVIOUS REVISION DATE: JANUARY 7, 2010
 APPROVED: *[Signature]* DATE: 2/24/17
 VERNE SKAGERBERG, TRANSPORTATION PLANNER, FOR
 ANDY HUGHES, CHIEF OF PLANNING

FAA AIRSPACE REVIEW NO: _____
 FAA APPROVAL DATE: _____
 BY: _____
 FAA AIRPORT DIVISION, ALASKA REGION, AAL-600
 SUBJECT TO CONDITIONS IN LETTER DATED: _____
 PREVIOUS ALP FAA APPROVAL DATE: JUNE 2, 2006

YAKUTAT AIRPORT
 AIRPORT AIRSPACE PROFILES

SHEET
 8 OF 10

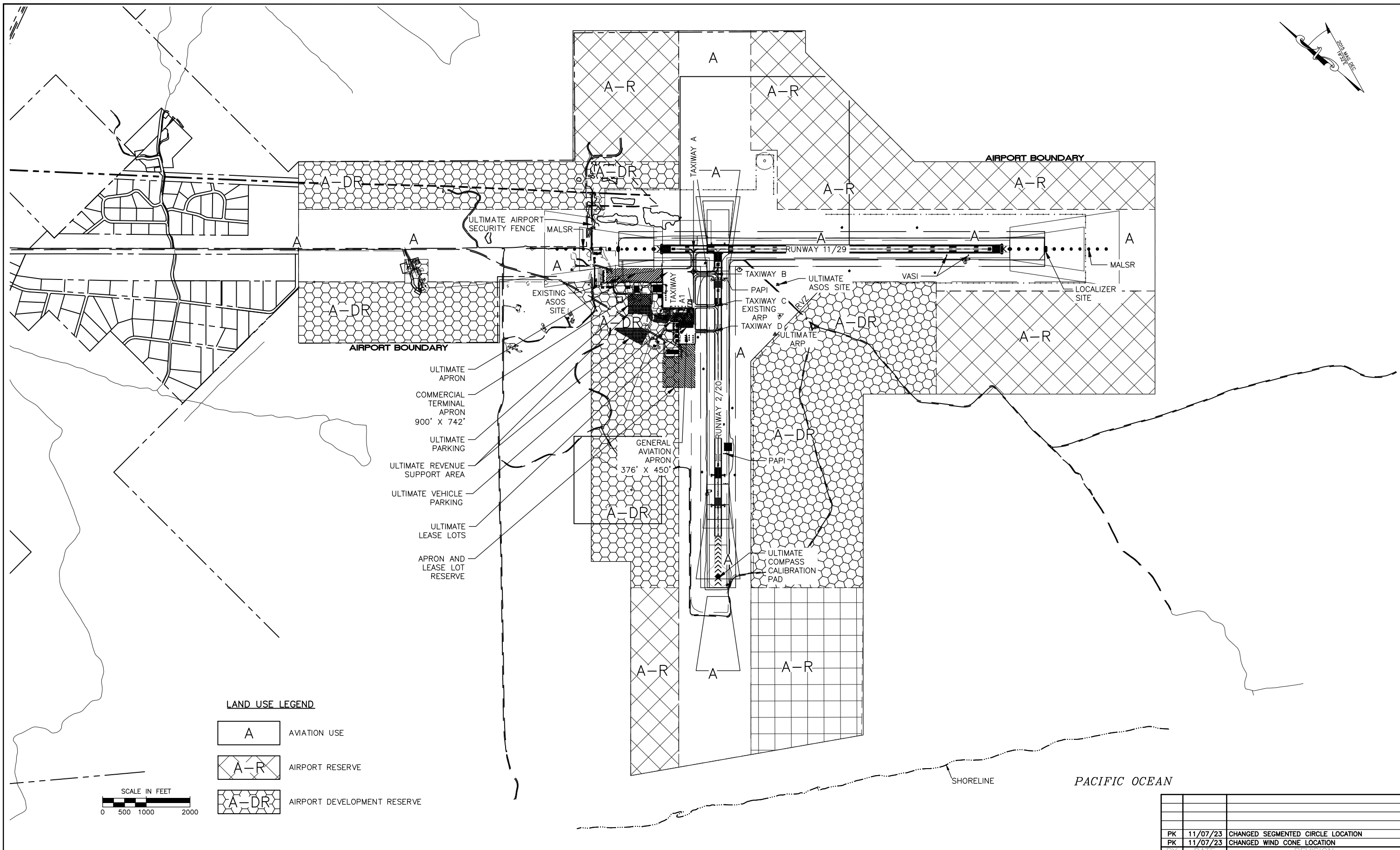
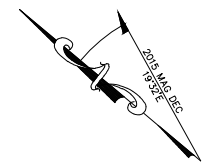

- ULTIMATE APRON
- COMMERCIAL TERMINAL APRON 900' X 742'
- ULTIMATE PARKING
- ULTIMATE REVENUE SUPPORT AREA
- ULTIMATE VEHICLE PARKING
- ULTIMATE LEASE LOTS
- APRON AND LEASE LOT RESERVE

LAND USE LEGEND

A	AVIATION USE
A-R	AIRPORT RESERVE
A-DR	AIRPORT DEVELOPMENT RESERVE

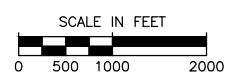

PK	11/07/23	CHANGED SEGMENTED CIRCLE LOCATION
PK	11/07/23	CHANGED WIND CONE LOCATION
BY	DATE	REVISION

PLANNED: MIM
 DRAWN: JC
 CHECKED: EJJ
 DATE: 2/24/2017

STATE OF ALASKA
 DEPARTMENT OF TRANSPORTATION
 AND PUBLIC FACILITIES
 SOUTHCOST REGION PLANNING

PREVIOUS REVISION DATE: JANUARY 7, 2010
 APPROVED:
 _____ DATE:
 VERNE SKAGERBERG, TRANSPORTATION PLANNER, FOR
 ANDY HUGHES, CHIEF OF PLANNING

FAA AIRSPACE REVIEW NO: _____
 FAA APPROVAL DATE: _____
 BY: _____
 FAA AIRPORT DIVISION, ALASKA REGION, AAL-600
 SUBJECT TO CONDITIONS IN LETTER DATED: _____
 PREVIOUS ALP FAA APPROVAL DATE: JUNE 2, 2006

**YAKUTAT AIRPORT
 LAND USE DRAWING**

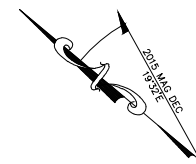

TRACT I

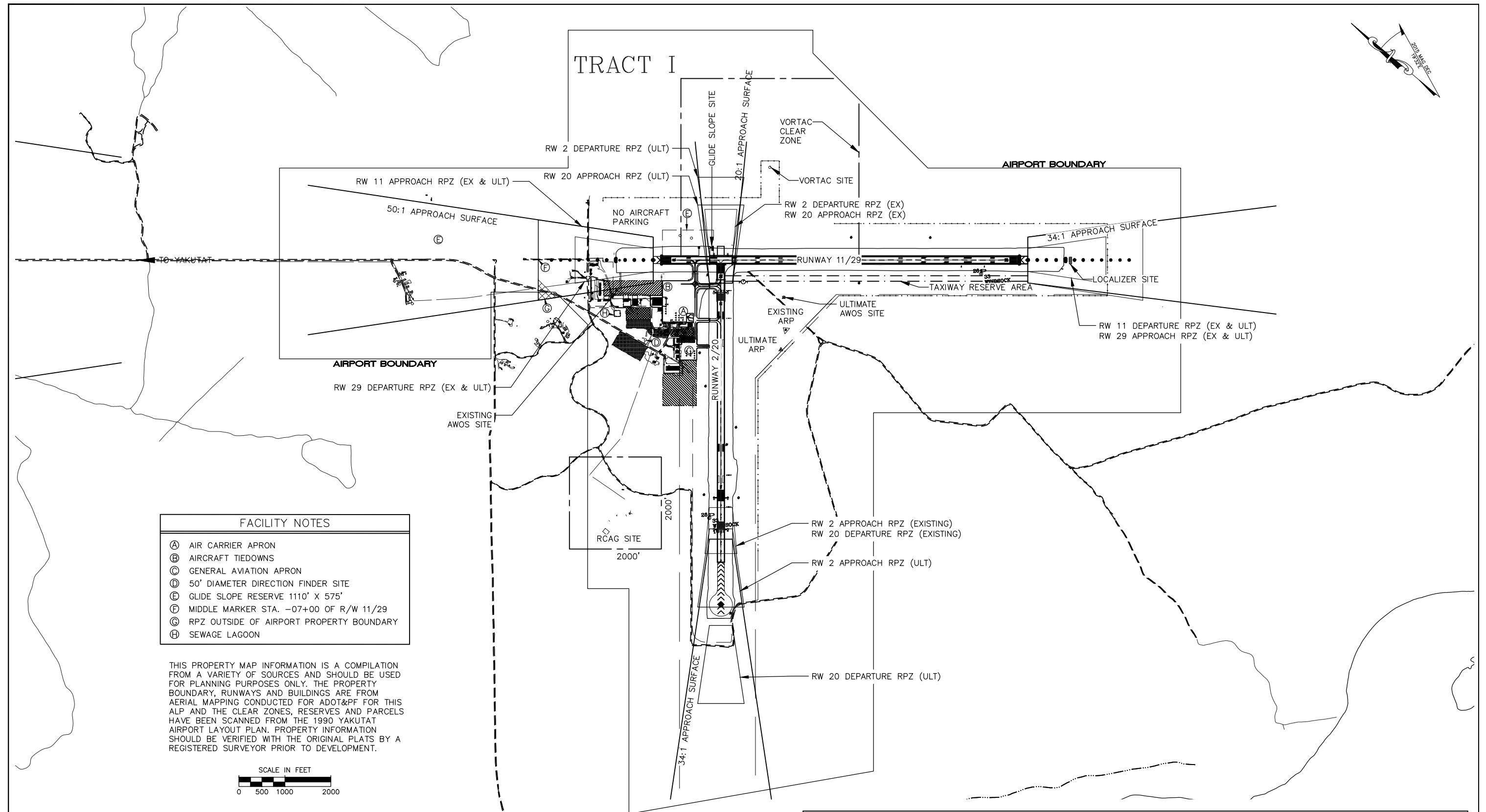

FACILITY NOTES	
(A)	AIR CARRIER APRON
(B)	AIRCRAFT TIEDOWNS
(C)	GENERAL AVIATION APRON
(D)	50' DIAMETER DIRECTION FINDER SITE
(E)	GLIDE SLOPE RESERVE 1110' X 575'
(F)	MIDDLE MARKER STA. -07+00 OF R/W 11/29
(G)	RPZ OUTSIDE OF AIRPORT PROPERTY BOUNDARY
(H)	SEWAGE LAGOON

THIS PROPERTY MAP INFORMATION IS A COMPILATION FROM A VARIETY OF SOURCES AND SHOULD BE USED FOR PLANNING PURPOSES ONLY. THE PROPERTY BOUNDARY, RUNWAYS AND BUILDINGS ARE FROM AERIAL MAPPING CONDUCTED FOR ADOT&PF FOR THIS ALP AND THE CLEAR ZONES, RESERVES AND PARCELS HAVE BEEN SCANNED FROM THE 1990 YAKUTAT AIRPORT LAYOUT PLAN. PROPERTY INFORMATION SHOULD BE VERIFIED WITH THE ORIGINAL PLATS BY A REGISTERED SURVEYOR PRIOR TO DEVELOPMENT.

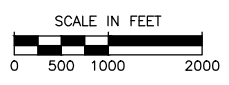

AIRPORT PROPERTY STATUS								
PARCEL	GRANTOR	GRANTEE	INTEREST	ACREAGE	BOOK & PAGE	RECORDING DATE	AIP ACQUISITION NO. & DATE	REMARKS
TRACT 1	U.S. GOVERNMENT	STATE OF ALASKA	DEED	3600+/-	Bk.80, P.55	1-15-66	SECT. 45, Omnibus Act	Recorded in Juneau Rec. Dist.

PK	DATE	REVISION
PK	11/07/23	CHANGED SEGMENTED CIRCLE LOCATION
PK	11/07/23	CHANGED WIND CONE LOCATION

PLANNED: MIM
 DRAWN: JC
 CHECKED: EJC
 DATE: 2/24/2017

STATE OF ALASKA
 DEPARTMENT OF TRANSPORTATION
 AND PUBLIC FACILITIES
 SOUTHCOAST REGION PLANNING

PREVIOUS REVISION DATE: JANUARY 7, 2010
 APPROVED:
 VERNE SKAGERBERG, TRANSPORTATION PLANNER, FOR
 ANDY HUGHES, CHIEF OF PLANNING

FAA AIRSPACE REVIEW NO:
 FAA APPROVAL DATE:
 BY:
 FAA AIRPORT DIVISION, ALASKA REGION, AAL-600
 SUBJECT TO CONDITIONS IN LETTER DATED:
 PREVIOUS ALP FAA APPROVAL DATE: JUNE 2, 2006

YAKUTAT AIRPORT
 AIRPORT PROPERTY MAP

SHEET
 10 OF 10